

CNU ACADEMIC CHARTER AWARDS 2005

SUBMISSION MATERIAL

These drawings depict a central location of the corridor in the primary study area that was a trailer park. The proposal envisions the redeveloped block anchoring a neighborhood centre involving mixed-use, mixed income housing. The illustration shows a conceptual showroom for a local boutique auto dealership.



Plan

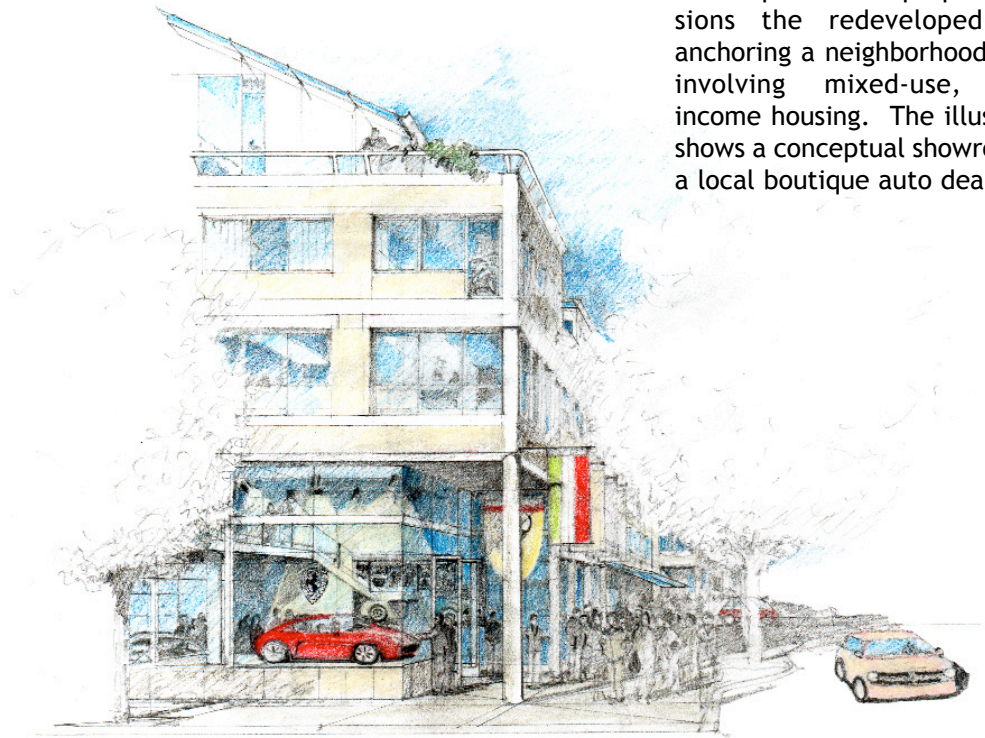

Neighborhood Centre Cross-Section